

L.F. Driscoll News

L.F. Driscoll Co. - The Success of Your Project is the Foundation of our Future

Vol. 4 No.5 - Winter 2003

L.F. Driscoll Co. "Tops Out" Citizens Bank Park

The ceremonial beam is set into place at the ballpark



Workers posing with the signed ceremonial steel beam. Courtesy of the Philadelphia Phillies.

L.F. Driscoll Co., along with joint venture partner the Hunt Construction Group in association with Synterra, Ltd. and Don Todd Associates, Inc., celebrated the completion of the steel framework at the Philadelphia Phillies' Citizens Bank Park with an official "Topping Out Ceremony, held on August 12th. The ceremony included the

signing of a ceremonial steel beam by more than 700 construction workers, as well as Phillies General Partner and President David Montgomery, Chairman Bill Giles; Vice President and General Manager Ed Wade; Manager Larry Bowa, Catcher Mike Lieberthal; and Left Fielder Pat Burrell. The beam was then hoisted to a light tower at one of the highest points in the ballpark to the song, "I'm Proud to Be An American."

"With the completion of the steel framework for Citizens Bank Park we can see the seating bowl and concourses and begin to understand the world-class character of this facility," said Montgomery. "Look around you and you'll see nearly 12,000 pieces of steel. It's a tremendous feat. We have the ironworkers and the many others who are out here every day to thank for it."

Larry Bowa, Mike Lieberthal, and Pat Burrell proved to be fan favorites as they

mingled with workers and signed many autographs. Attendees were also invited to enjoy food and refreshments courtesy of McDonald's, Hatfield Hot Dog, and Aramark.

The 43,000-seat world-class Citizens Bank Park is opening April 2004. To view the progress of the ballpark, go to www.phillies.com and click on the Web Cam.



The ceremonial steel being raised to the highest light tower. Courtesy of the Philadelphia Phillies.

Breaking Ground at Atlantic City Medical Center

The largest expansion in the hospital's history

L.F. Driscoll Co. joined Atlantic City Medical Center in breaking ground on September 16th at the Mainland Division for the largest expansion in the hospital's recent history.

L.F. Driscoll, AtlantiCare and APMC executives, Board members and staff, along

with Galloway Township Mayor Chuck Endicott, used a giant front-end loader to break ground, instead of the traditional shovel, to underscore the size and significance of the project.

The \$30 million expansion will add 67,500 square feet to the existing hospital. The new Maternal Newborn Center and the new Emergency Department will each be at least twice the size of the existing departments.

Mainland's new emergency department will feature 24 acute and specialty care rooms, four major treatment and resuscitation rooms, four fast-track rooms, decontamination rooms, child-friendly waiting rooms, as well as digital radiography and CT scans.

(continued on page 2)



Rendering of Atlantic City Medical Center. Courtesy of Granary Associates.

On the Inside...

2

Current Clients
More on APMC
Unveiling the South Tower

3

President's Message
L.F. Driscoll Wins Award

4-5

Lancaster General Hospital
special feature



L.F. Driscoll Co. would like to thank our current clients

- ♦ Abington Memorial Hospital
- ♦ The Academy of Music
- ♦ ADR 1601 Locust, LP
- ♦ Albert Einstein Healthcare Network
- ♦ AtlantiCare
- ♦ The Children's Hospital of Philadelphia
- ♦ Fox Companies
- ♦ Gordon Group Holdings, LLC
- ♦ The Granary Associates
- ♦ Homewood Suites
- ♦ Hope Partnership for Education
- ♦ University of Pennsylvania Health System
- ♦ KLMK Group, LLC
- ♦ Lancaster General Hospital
- ♦ Liberty Property Trust
- ♦ Marriott Ownership Resorts, Int'l
- ♦ The McGee Company
- ♦ Our Lady of Lourdes Medical Center
- ♦ Patrinely Group
- ♦ The Ronald McDonald House
- ♦ Philadelphia Museum of Art
- ♦ Philadelphia Phillies
- ♦ Robert Wood Johnson Health Network
- ♦ South Jersey Hospital, Inc.
- ♦ St. James Associates
- ♦ Stout Road Associates



ACMC Groundbreaking

(continued from page 1)

"We are treating more patients in our ED than ever before," said John Becher, D.O., chairman of emergency services at ACMC. "Our aging community requires access to care 24 hours a day, seven days a week, and the area's population has increased tremendously over the past few years." Becher said the expanded ED will enable ACMC to accommodate the approximately 37,500 emergency patient visits it receives each year.

The Maternal Newborn Center will include eight private labor/delivery/recovery rooms, two C-section rooms, five ante-partum beds, 28 post-partum beds, 28 bassinets in the "well baby" nursery, 13 intermediate neonatal bassinets, 9 neonatal intensive care bassinets in the NICU, state-of-the-art infant security, overnight accommodations for parents of sick infants, whirlpool bath

and shower, and internet access. It is part of AtlantiCare's Women's Health and Wellness program, which offers a full range of preventive, diagnostic and treatment services designed to fit the individual needs of women at every stage of life. The center, designed to look and feel like a luxury hotel, will feature private labor/delivery rooms, perinatology services and classrooms for women's health education. The unit will occupy a portion of the first floor and the entire second and third floors of the new building.

Mainland will also become home to ACMC's neonatal intensive care unit, which will have 10 bassinets for premature and sick infants. This state-of-the-art women's pavilion will also have perinatology testing and classrooms for women's health and wellness education.

Unveiling the South Tower at The Children's Hospital of Philadelphia

The grand opening of the South Tower was marked by a ribbon cutting ceremony that took place on the 9th floor of the South Tower on October 16th. The ceremony was followed by a reception and guided tours, for dignitaries and hospital employees, of the 5th and 6th floors of the building.

The ceremony marks the completion of Phase One in the Hospital's \$650-million multiphase facilities expansion program, which ultimately will nearly double the size of the main campus and is among the largest Healthcare expansion programs in the nation. The addition of the state-of-the-art facility increased the Hospital's capacity from 381 to 430 beds with additional future expansion space available. The new construction is a strategic response to a 25 percent growth in inpatient volume and emergency department visits over the past five years.

The South Tower's floor area covers more than 309,000 square feet. Each of the South Tower's 146 private patient rooms is an expansive 335-square feet. A state-of-the-art facility, the new patient rooms and

surrounding floor space are filled with innovative features - containing everything from non-splash sink, desks, DVD players and computer hook-ups for parents.

Clinical staff, parent, and patient advisory councils worked closely with construction manager L.F. Driscoll Co. and various design professionals during the last two years to provide extensive input regarding these design features.



Stephen M. Altschuler, M.D., President & CEO and Richard M. Armstrong, Jr. Chairman, Board of Trustees for the Children's Hospital of Philadelphia join patients in cutting the ceremonial ribbon.



Due to growth in the nation's population and the increasing number of aging baby boomers, hospitals and medical facilities are racing to keep up with patients' demands. The result: an increasing need for larger and more technically advanced medical facilities.

Most healthcare construction takes

President's Message

place on active campuses that can never shut down. Strategic planning and phasing are the norms for even the smallest renovation. Procedures taken to protect the patients' health and comfort coupled with the absence of disruption and inconvenience in hospital routine, make L.F. Driscoll the most sought after Construction Manager in the area today. On a daily basis, our project teams tackle major problems while working in a sensitive and antiseptic environment, and they succeed in satisfying the hospital's demands for a quiet, nondisruptive and clean operation.

Our reputation has grown as evidenced in the extensive additions now being performed at Lancaster General Hospital, Atlantic City Medical Center, Our Lady of Lourdes, the new construc-

tion of the South Jersey Regional Medical Center, and by the addition of our newest clients, Albert Einstein Medical Center and Robert Wood Johnson Medical Center. Long years of successful experience at The Children's Hospital of Philadelphia, the Hospital of the University of Pennsylvania, and Abington Memorial Hospital reinforce the confidence these major healthcare institutions have entrusted in our abilities as construction managers.

I am extremely proud of the service we provide to the healthcare industry and consider it an honor to serve so many communities throughout the region.

The Academy of Music Wins Nat'l Reconstruction & Renovation Award

L.F. Driscoll Co. was recently honored with the Reconstruction and Renovation of the Year Award for bringing the "Grand Old Lady" of Broad & Locust St. into the 21st century. This is an annually recognized award granted to only those projects that have demonstrated exceptional abilities in preserving historical buildings throughout the nation.

L.F. Driscoll Co. proved worthy of this recognition through substituting virtually irreplaceable elements with materials of equal caliber in order to keep consistent with the history of the original building. The goal of the project was to allow the installation of the work without impacting the historic fabric of the building. As a result of the diligence and hard

work of all those working on the project, the Academy of Music has been recognized as one of the nation's most renowned landmarks that still remains active today.

The Academy of Music has been featured, along with other award winning projects, in the October 2003 issue of Building, Design & Construction Magazine.



Interior shot of the historic Academy of Music

About Us...

The L.F. Driscoll Co. was founded more than seventy years ago and has grown to be the largest locally-based construction management firm in the region. The firm's growth stems from its strong reputation for delivering quality projects in a timely and cost-effective manner. Current projects include The Philadelphia Phillies' Citizens Bank Park, Children's Hospital of Philadelphia, 1601 Locust Street, Abington Memorial Hospital, Albert Einstein Medical Center, Homewood Suites, Hope Partnership for Education, The Hospital of the University of Pennsylvania, Lancaster General Hospital, Our Lady of Lourdes Hospital, Robert Wood Johnson Healthcare Network, South Jersey Medical Center, and the St. James Place. L.F. Driscoll recently completed Philadelphia's latest landmark, the Kimmel Center for the Performing Arts.

About L.F. Driscoll News...

L.F. Driscoll News is published periodically by L.F. Driscoll Co. For more information, to submit job leads or to suggest topics for future editions, please contact Al Fazzini, Director of Marketing, at (610) 668-0950 or afazzini@lfdiscoll.com.

The Challenge of Expanding

L.F. Driscoll Co. is in the process of constructing a two-year expansion project for Lancaster General Hospital. The \$58 million expansion project includes construction of a 350,700-square-foot new Orthopedic Center. This includes 82,000 square feet in renovations and additions to the existing hospital. The overall goal of the project is to construct new additions that will enhance inpatient and surgical capacity and parking for patients and visitors.

The completed Orthopedic Center will consist of a new, three-story addition. This addition will be dedicated to the unique and diverse needs of orthopedic patients at virtually every stage of life. The facility will include seven custom designed, state-of-the-art orthopedic surgical suites for inpatient and outpatient surgeries, 42 hospital private patient rooms, advanced physical and occupational therapy, inpatient rehabilitation, and a full complement of other hospital services.

The surgical services to be provided at the Lancaster General Orthopedic Center will include reconstructive surgery, joint care, arthroscopic and microscopic surgery, treatment of back and spinal disorders, sports medicine, traumatic injury care, repairing of complex fractures, and treatment of shoulder, hand and ankle problems.

The Lime Street building will receive a five-story addition extending the structure to nine stories. This new addition, which will be located above the hospital's operating rooms, will house a new unit to handle the sterilization and storage of equipment used in all surgical procedures at the hospital.

Additional expansions will include a new improved main entrance complete with a fountain and driveway and a new pa-

"It is a constant challenge to expand and add to an already functioning hospital in an urban setting without disturbing those administering and receiving crucial care."

- Jerry Seitzinger

tient circulation tower which will add 4 elevators to the center of the hospital.

In constructing the expansion for Lancaster General Hospital, L.F. Driscoll's project team led by Jeff Hutwelker, Jerry Seitzinger, & Joe Amicone continue to face many challenges. "It is a constant challenge to expand and add to an already functioning hospital in an urban setting without disturbing those administering and receiving crucial care," states project manager Jerry Seitzinger.

The first challenge that the project team faced was installing the new sewer system and underground detention basin on East James Street. The contractors were forced to line drill and hoe-ram through 10 feet of solid limestone bedrock to install the system. The stone was so deep and dense that vibrations could be felt by hospital residents and neighboring houses to the facility. The team had to limit hammering to certain times of the day in order to not disturb the hospital and the neighboring community.

One of the biggest challenges the workers face is constructing the addition over top of the existing Lime Street Building. Workers take extreme caution in constructing this five floor addition since it is located directly above the hospital's



Rendering of Lancaster General Hospital. Courtesy of IKM Incorporated.



Rendering of LGH Orthopedic Center. Courtesy of IKM Incorporated.

Lancaster General Hospital

open heart and brain surgery operating rooms.

To prevent fumes from the construction site from seeping into the hospital's ORs, the L.F. Driscoll team devised a plan to create "chimney like" structures to prevent fumes from entering the hospital HVAC system. The chimneys act as suction devices and have been successfully responsible for protecting the facility from objectionable odors.

The new connecting link that is being constructed to join the existing hospital to the Lime Street building is being constructed in a new, innovative way. To provide the bridge with necessary support, the team is installing a shear wall in the switch gear control center, a difficult feat. Shear walls are devised to strengthen structures from outside forces such as wind, blasts, and earthquakes.

"Normally installing a shear wall would not be that difficult. However, due to the existing conditions and location of this wall, we have been coordinating with the hospital's plant engineering dept. to minimize the impact to this area," remarks Assistant Superintendent Andy Walters.

When all of the challenges are met and the expansion project is complete in December 2004, Lancaster General Hospital will have the ability to treat more patients than ever before. Inpatient bed capacity at the Duke Street Hospital will increase from 446 to 498 beds. The number of operating rooms at LGH will increase from 25 to 32. The Post-Anesthesia Care Unit will expand from 29 to 39 beds. Beds in the hospital's Day Surgery unit will increase from 20 to 36.



Rendering of the interior of the Orthopedic Center and first floor layout plan. Courtesy of IKM Incorporated.

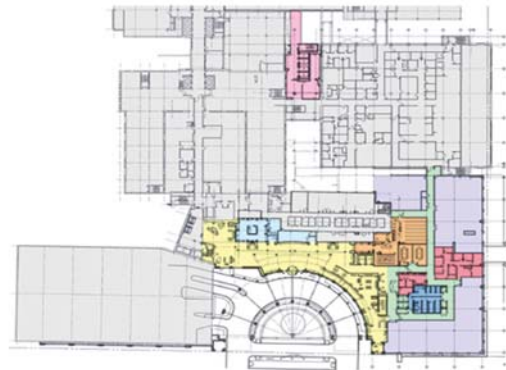

Project Profile

Lancaster General Hospital

Owner:
Lancaster General Hospital

Architect:
IKM Incorporated

Officer-In-Charge:
Frederick W. Slack, III

Project Executive:
Jeff Hutwelker

Project Managers:
Joe Amicone & Jerry Seitzinger

Superintendent:
Jack Garrett

Square footage:
350,700 - new construction
82,000 - renovations and additions





*Rendering of the Children's Hospital of Philadelphia
Courtesy of Kohn Pederson Fox*



Award winning
projects, award
winning team



L.F. Driscoll Co.
Construction Management

P.O. Box 468
9 Presidential Blvd.
Bala Cynwyd, PA 19004-0468
Tel (610) 668-0950
Fax (610) 668-9425
www.lfdriscoll.com